

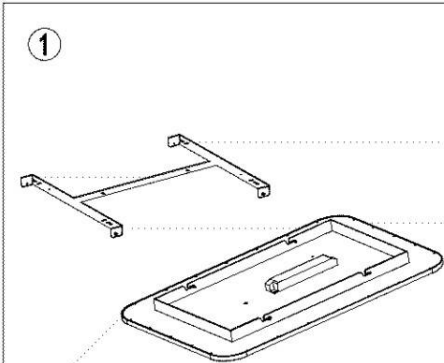

- Installation and wiring of luminaire must be in accordance with all applicable local codes.
- Installation, inspection, and maintenance of luminaires should be performed by a qualified electrician.
- DO NOT make or alter any open holes in the luminaire. Do not modify the luminaire.
- DO NOT install damaged product.
- Make sure electrical power is OFF before and during installation and maintenance.
- Make sure the equipment is properly grounded.
- Make sure the supply voltage is same as the rated fixture voltage.



The picture is for reference only, the actual product shall prevail!
Warning: Cut off the power supply before installation to prevent electric shock!

Screw		X4
Screw		X4

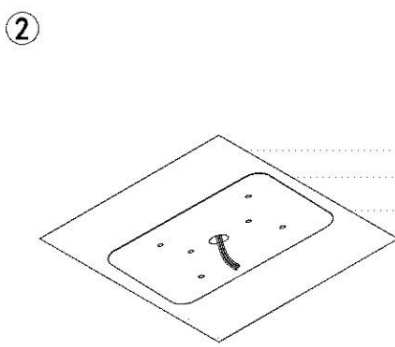

First select the place to be installed, place the ceiling bracket in the mounting position, and mark it with a pen core

Then drill holes for screw A of the corresponding size. If you need to hide the outlet, An AC line control needs to be reserved in the middle of the ceiling

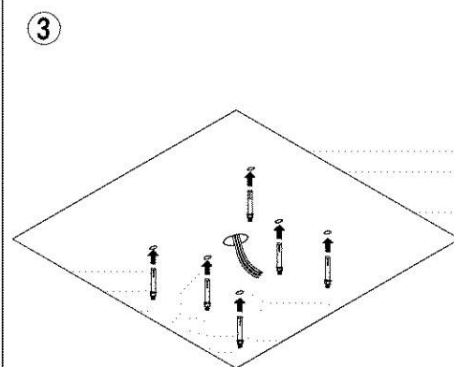

Insert screw A into the hole

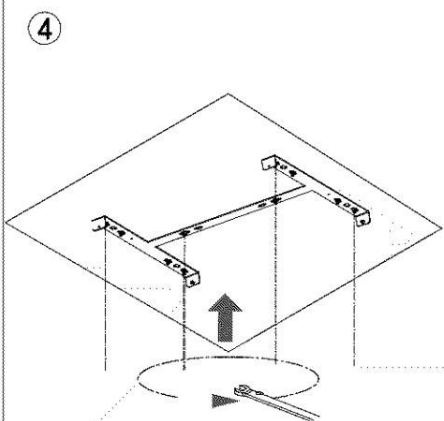

Take out 4 screws B and use a screwdriver to fix the ceiling bracket to the ceiling.

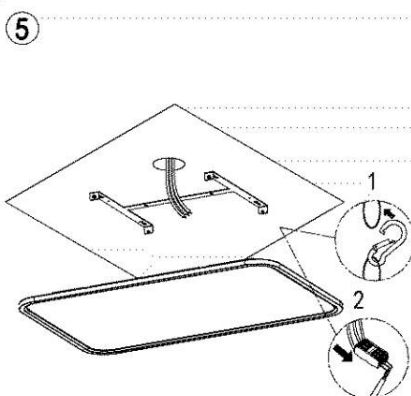

1. Connect the ceiling AC wire to the plate terminal, wiring method: (L-live wire) (N-neutral wire) (-ground wire)

2. Hang up the anti-fall rope

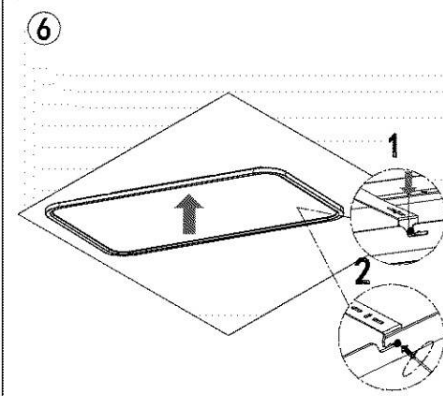

Lift the frame of the lamp and align the four notches with the four installation pillars of the ceiling bracket.

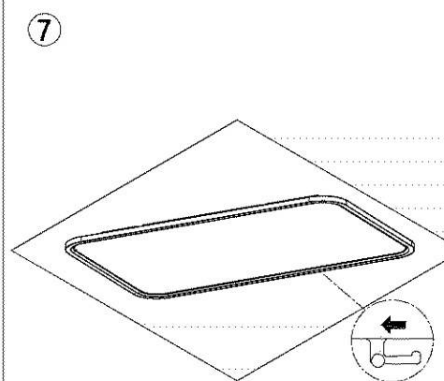

Rotate the frame of the lamp clockwise so that it locks into place with the ceiling bracket.

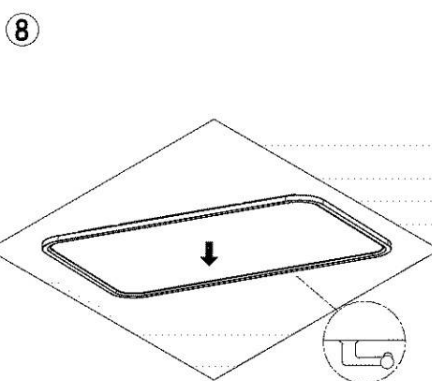

Make sure that the frame of the lamp is securely attached to the ceiling bracket.

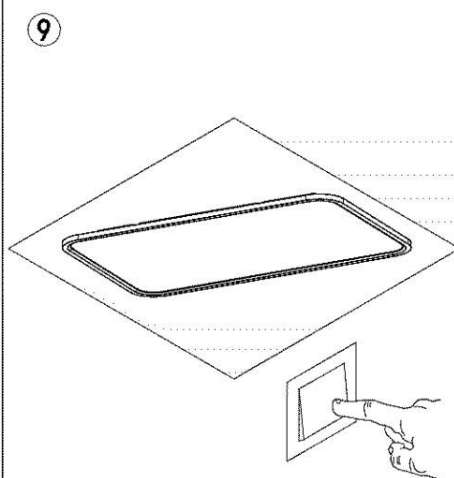

After installation, turn on the power and light up the lamps.